

SCHEDULE OF COMB. FOUNDATION :- (M20 AND FE 500)

MNO.	SIZE (mm)	DEPTH OF BASE SLAB	REINFORCEMENT	
			SHORTER(f)	LONGER(e)
COMB-1	AS SHOWN	500	12@150 C/C	12@150 C/C
COMB-2	AS SHOWN	500	12@150 C/C	10@150 C/C
COMB-3	AS SHOWN	500	12@150 C/C	12@150 C/C
COMB-4	AS SHOWN	450	12@150 C/C	10@150 C/C
COMB-5	AS SHOWN	500	12@150 C/C	10@150 C/C
COMB-6	AS SHOWN	450	12@150 C/C	10@150 C/C
COMB-7	AS SHOWN	450	12@150 C/C	10@150 C/C
COMB-8	AS SHOWN	500	12@150 C/C	12@150 C/C
COMB-9	AS SHOWN	450	12@150 C/C	10@150 C/C

SCHEDULE OF FOUNDATION :- (M20 AND FE 500)

MNO.	SIZE (mm)		DEPTH OF BASE SLAB	REINFORCEMENT	
	W	L		SHORTER(f)	LONGER(e)
F1	2400	2400	450	12@150 C/C BOTH WAYS OF BOTTOM.	
F2	2500	2500	450	12@150 C/C BOTH WAYS OF BOTTOM.	
F3	2600	2600	450	12@150 C/C BOTH WAYS OF BOTTOM.	
F4	2800	2800	500	12@150 C/C BOTH WAYS OF BOTTOM.	
F5	3000	3000	500	12@150 C/C BOTH WAYS OF BOTTOM.	
F6	3200	3200	500	12@150 C/C BOTH WAYS OF BOTTOM.	
F7	3000	3400	500	12@150 C/C BOTH WAYS OF BOTTOM.	
F8	2800	3200	500	12@150 C/C BOTH WAYS OF BOTTOM.	
F9	2600	3000	500	12@150 C/C BOTH WAYS OF BOTTOM.	

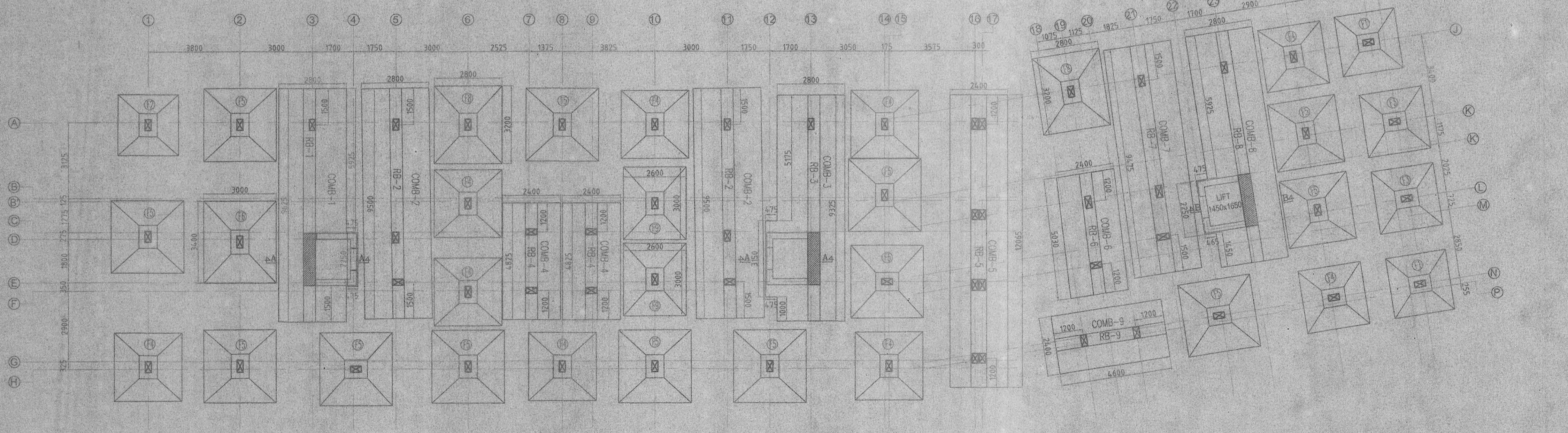
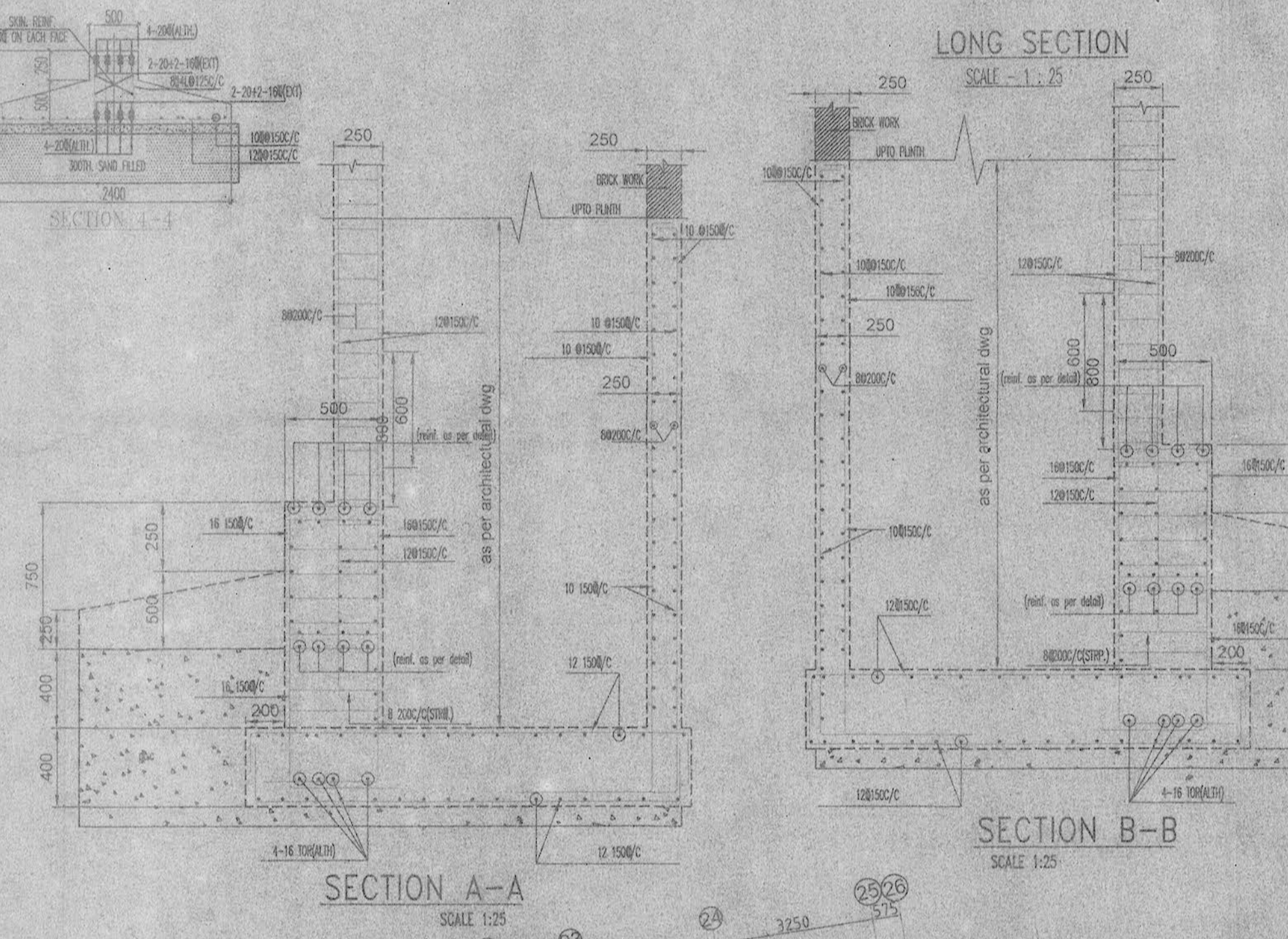

FOUNDATION LAYOUT PLAN
BLOCK-3

- ALL DIMENSIONS ARE IN MM
 - CONCRETE GRADE TO BE ADOPTED M20 UNLESS MENTIONED.
 - COVER TO REINFORCEMENT
 - COLUMN = 40mm, BEAM = 30mm, SLAB = 15mm, FOUNDATION = 50mm
 - DO NOT SCALE THE DRAWING - FOLLOW WITH DIMENSION
 - ALL EXTERNAL WALLS ARE 200mm THK & INTERNAL WALLS ARE
 - LEAN CONCRETE (1:3:6) NOMINAL MIX 75 THK SHALL BE PROVIDED
 - EXTERNAL PLASTER 15mm THK IN CEMENT MORTAR GRADE (1:4)
 - INTERNAL PLASTER 12mm THK IN CEMENT MORTAR GRADE (1:4)
 - ALL CEILING PLASTER 6mm THK IN CEMENT MORTAR GRADE (1:4)
 - USE 200 GSM LDP SHEET BELOW P.C.C.
- NB: THE STRUCTURAL DESIGNER IS RESPONSIBLE FOR THE DESIGN ONLY THE CONSTRUCTION SUPERVISION FALLS OUTSIDE THE PERVIEW OF

DECLARATION OF E.B.A.
I HAVE CERTIFIED ON THE PLAN ITSELF WITH FULL RESPONSIBILITY THAT BUILDING RULES 1990 AS AMENDED FROM TIME TO TIME AND THAT THE SITE CONDITIONS INCLUDING THE BUTTING ROAD CONFORM WITH THE PLAN AND THAT IT IS A BUILDABLE SITE AND NOT A TANK OR A FILLED UP LAND.

SUBIR CHANDRA SANYAL
B.C.E., A.M.I., STRUCT. E. (I)
E.S. NO. 007, CLASS-I
RAJPUR-SONARPUR MUNICIPALITY

SIGNATURE OF E.B.A.

STRUCTURAL CERTIFICATE

THE STRUCTURAL DESIGN AND DRAWING OF BOTH FOUNDATION AND SUPER STRUCTURE OF THE BUILDING HAS BEEN MADE BY ME CONSIDERING ALL POSSIBLE LOADS INCLUDING THE SEISMIC LOAD AS PER NATIONAL BUILDING CODE OF INDIA AND CERTIFIED THAT IT IS SAFE AND STABLE IN ALL RESPECT

SUBIR CHANDRA SANYAL
B.C.E., A.M.I., STRUCT. E. (I)
E.S. NO. 007, CLASS-I
RAJPUR-SONARPUR MUNICIPALITY

SIGNATURE OF STRUCTURAL ENGINEER (E.S.E. NO. 007)

ALOK ROY
Enlisted Geotechnical Engineer
Rajpur-Sonarpur Municipality
No.- 008 / G.T. Eng. Class-I

SIGNATURE OF GEOTECHNICAL ENGINEER

As a Party Constituted Jointly by the Party Constituted Attorney of
AKHILA MONDAL, JAMAL UDDIN MONDAL, REHATULLA MONDAL, KAMAL UDDIN MONDAL, NABIRUL MONDAL, SAMAUDDIN MONDAL, NURJEHAR BIBI SARDAR SAALAUDDIN MONDAL, NURABAN MONDAL, MAHAMUDA BIBI, MUHAMMAD MONDAL, MAJID MONDAL, MUHAMMAD MONDAL, EKIDA SEKH, MUHAMMAD MONDAL, RASIDA BIBI, SHAKALI MONDAL, OSHIMAZI

SUBIR CHANDRA SANYAL
B.C.E., A.M.I., STRUCT. E. (I)
E.S. NO. 007, CLASS-I
RAJPUR-SONARPUR MUNICIPALITY

SIGNATURE OF E.B.A.

PROJECT: KESHIDA BIBI SEKH
STRUCTURAL DRAWING FOR A PROPOSED G+IV STORIED RESIDENTIAL BUILDING AT AT HOLDING NO. 513, PAIKPARA ROAD, R.S.DAG NO. 2307, L.R. DAG NO. -2300, 2297-2299, 2287, 2286, R.S. KHATIAN NO. - 440, L.R. KHATIA NO. - 578, 2359 - 2369, 2375-2379, J.L. NO. - 56, WARD NO. 26, MOUZA- UKHILA PAIKPARA, P.S.-SONARPUR, DIST.-24PGS.(S), UNDER RAJPUR SONARPUR MUNICIPALITY

NAME OF OWNER: SAHABUDDIN MONDAL AND OTHERS

DRAWN - sumpa	SCALE - 1:100
DESIGNED - sumpa	DATE - 20.04.2018
CHECKED - euparna	JOB NO
APPROVED	

Sanyalson Associates
CONSULTANT PLANNER & STRUCTURAL ENGINEERS
P-157, KANUNGO PARK, KOLKATA-84

DWG NO. 05/07 BLOCK - 3

APPROVAL OF SAE

Structural plan as submitted has been kept with OFFICE USE ONLY have been kept with Building Plan No. 107/05/26/23. Date: 11/09/2018 for record of the Rajpur-Sonarpur Municipality without Verification No. deviation from the submitted structural plan should be made at the time of erection without submitting fresh structural plan along with design calculation and stability certificate in the prescribed form necessary steps should be taken for the safety of the adjoining premises public private properties and safety of human life during construction.

Sig. of Assistant Engineer,
RAJPUR-SONARPUR MUNICIPALITY